



SAL4.27

Name: **Cable lug with shear head bolts**

Al/Cu 150-300 mm² ø 13 mm

Type: SAL4.27

GTIN: 6418677401503

Description: The cable lugs are used for terminating conductors of up to 1 kV cables. Because of the shear head bolt construction no crimping tools are needed. The required torque is achieved by tightening the bolt until it breaks off. The lugs are longitudinally water tight and they are suitable both for aluminium and copper conductors, solid and stranded, sector shaped and circular.

Package: 50/2250

Unit: PCS



Photo presented is indicative only

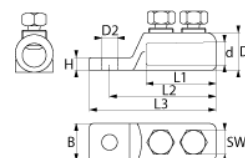

Technical specification

Ratings

ETIM class Screw cable lug

Dimensions

Weight 0.322 kg

Conductor size Al/Cu 150-300 mm²

Drawing markings

B	42 mm
d	25 mm
D1	42 mm
D2	13 mm
H	13 mm
L1	71 mm
L2	111 mm
L3	132 mm
SW	22 mm

ETIM

Nominal cross section copper, RM	150 ... 300 mm ²
Nominal cross section copper, RE	150 ... 300 mm ²
Nominal cross section copper, SM	150 ... 300 mm ²
Nominal cross section aluminium, RM	150 ... 300 mm ²
Nominal cross section aluminium, RE	150 ... 300 mm ²
Nominal cross section aluminium, SM	150 ... 300 mm ²
Nominal cross section aluminium, SE	150 ... 300 mm ²
Material conductor	Aluminium/copper
Surface protection	Tinned



SAL4.27

With shear-off head	x
Use:	The cable lugs are used for terminating conductors of up to 1 kV cables. The lugs are longitudinally water tight and they are suitable both for aluminium and copper conductors, solid and stranded, sector shaped and circular.
Construction:	Body: tinned aluminium alloy, tin layer thickness >12µm Screws: tinned aluminium alloy Grease: RFL3
Installation:	<ul style="list-style-type: none">- Remove insulation- Brush the conductor- Insert cable inside the cable lug- Tighten both screws a bit starting from the screw nearest insulation. Then continue tightening until screws break.
Tools required:	SW 22 wrench
Markings:	Ensto ww/yyyy SAL4.27 T2 Al/Cu 150-300mm ²
Standard:	EN 61238-1