



Saves Your Energy

PRODUCT SPECIFICATION

18.10.2015

1/2



SLJ3.47

Name: **Connector with shear head bolts**

Al/Cu 95-240 mm² 4 bolts

Type: SLJ3.47

GTIN: 6418677459726

Description: The connectors are used for jointing conductors of up to 1 kV cables. Because of the shear head bolt construction no crimping tools are needed. The required torque is achieved by tightening the bolt until it breaks off. The connectors are longitudinally water tight and they are suitable both for aluminium and copper conductors, solid and stranded, sector shaped and circular. The core insulation may be as well plastic as paper.



Photo presented is indicative only

Package: 50/2700

Unit: PCS

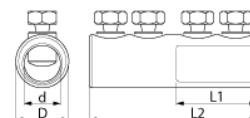

Technical specification

Ratings

ETIM class Connector to screw

Dimensions

Weight 0.278 kg

Conductor size Al/Cu 95-240

Drawing markings

d 25.5 mm

D 37.7 mm

L1 58 mm

L2 119 mm

ETIM

Nominal cross section copper, RM 95 ... 240 mm²

Nominal cross section copper, RE 95 ... 240 mm²

Nominal cross section copper, SM 95 ... 240 mm²

Nominal cross section aluminium, RM 95 ... 240 mm²

Nominal cross section aluminium, RE 95 ... 240 mm²

Nominal cross section aluminium, SM 95 ... 240 mm²

Nominal cross section aluminium, SE 95 ... 240 mm²

Material conductor Aluminium/copper

Surface protection Tinned

Oil stop/centre bar x

Insulation



Saves Your Energy

PRODUCT SPECIFICATION

18.10.2015

2/2



SLJ3.47

Use:	The connectors are used for jointing conductors of up to 1 kV cables. The connectors are longitudinally water tight and they are suitable both for aluminium and copper conductors, solid and stranded, sector shaped and circular.
Construction:	Body: tinned aluminium alloy, tin layer thickness >12µm Screws: tinned aluminium alloy Grease: RFL3
Installation:	<ul style="list-style-type: none">- Remove insulation- Brush the conductor- Insert cables inside the connector- Tighten screws from both sides a bit starting from the screw nearest insulation. Then continue tightening until screws break.
Tools required:	SW 18 wrench
Markings:	Ensto ww/yyyy SLJ3.47 Al/Cu 95-240mm ² Class A
Standard:	IEC 61238-1