



# SMJ1.27

Name: **Shear head bolt connector**

Al/Cu 10-95 mm<sup>2</sup>

Type: SMJ1.27

GTIN: 6418677446153

Description: The connector is used for jointing conductors of cables up to 36 kV. Because of the shear head bolt construction, no crimping tools are needed. The required torque is achieved by tightening the bolt until it breaks off. The adapter needed in tightening is included in the package.

The connector is water tight. It is suitable for aluminium and copper conductors: solid and stranded, sector shaped and circular. The cable core insulation may be plastic or paper.

Package: 1/10/2100

Unit: PCS



Photo presented is indicative only

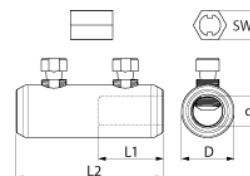

## Technical specification

### Ratings

ETIM class Connector to screw

### Dimensions

Weight 0.115 kg

Conductor size Al/Cu 10-95

### Features

For conductor shape Round, Sector, Solid, Stranded

### Drawing markings

d 14 mm

D 26 mm

L1 34 mm

L2 70 mm

SW 17 mm

### ETIM

Nominal cross section copper, RM 10 ... 95 mm<sup>2</sup>

Nominal cross section copper, RE 10 ... 95 mm<sup>2</sup>

Nominal cross section copper, SM 10 ... 95 mm<sup>2</sup>

Nominal cross section aluminium, RM 10 ... 95 mm<sup>2</sup>

Nominal cross section aluminium, RE 10 ... 95 mm<sup>2</sup>

Nominal cross section aluminium, SM 10 ... 95 mm<sup>2</sup>

Nominal cross section aluminium, SE 10 ... 95 mm<sup>2</sup>

Material conductor Aluminium/copper

Surface protection Tinned



# SMJ1.27

Use:	The connector is used for jointing conductors of cables up to 36 kV. It is suitable for aluminium and copper conductors: solid and stranded, sector shaped and circular.
Construction:	Body: tinned aluminium alloy, tin layer thickness min. 10µm Screws: tinned brass Centering ring: polypropylene Grease: RFL3 Tool: aluminium
Installation:	Follow installation instructions in the connector package.
Tools required:	SW17 wrench
Markings:	ENSTO WW/YY SMJ1.27 Al/Cu 10-95mm <sup>2</sup> Class A
Standard:	IEC61238-1