



Saves Your Energy

PRODUCT CARD

18.10.2015

1/2

SAL1.27

Name: **Cable lug with shear head bolts**

Al/Cu 6-50 mm² ø 8.5 mm

Type: SAL1.27

GTIN: 6418677401404

Description: The cable lugs are used for terminating conductors of up to 1 kV cables. Because of the shear head bolt construction no crimping tools are needed. The required torque is achieved by tightening the bolt until the head breaks off. The lugs are longitudinally water tight and they are suitable for both aluminium and copper conductors as well as for solid or stranded and sector shaped or circular conductors.

Package: 100/7000

Unit: PCS



Photo presented is indicative only

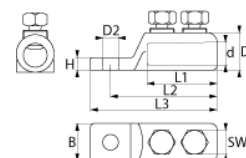

Technical specification

Ratings

ETIM class Screw cable lug

Dimensions

Weight 0.038 kg

Conductor size Al/Cu 6-50

Drawing markings

B	20 mm
d	10 mm
D1	20 mm
D2	8.5 mm
H	5.5 mm
L1	33 mm
L2	50 mm
L3	60 mm
SW	11 mm

ETIM

Nominal cross section copper, RM	6 ... 50 mm ²
Nominal cross section copper, RE	6 ... 50 mm ²
Nominal cross section copper, SM	6 ... 50 mm ²
Nominal cross section aluminium, RM	6 ... 50 mm ²
Nominal cross section aluminium, RE	6 ... 50 mm ²
Nominal cross section aluminium, SM	6 ... 50 mm ²
Nominal cross section aluminium, SE	6 ... 50 mm ²
Material conductor	Aluminium/copper
Surface protection	Tinned

Ensto Finland Oy

Ensio Miettisen katu 2
P.O.Box 77
06101 Porvoo, Finland

Tel. +358 204 76 21
Fax +358 204 76 2770

www.ensto.com



Saves Your Energy

PRODUCT CARD

18.10.2015

2/2

SAL1.27

With shear-off head

x

Ensto Finland Oy

Ensio Miettisen katu 2
P.O.Box 77
06101 Porvoo, Finland

Tel. +358 204 76 21
Fax +358 204 76 2770

www.ensto.com