



Saves Your Energy

## PRODUCT CARD

18.10.2015

1/2

# SAL3.27

Name: **Cable lug with shear head bolts**

Al/Cu 95-185 mm<sup>2</sup> ø 13 mm

Type: SAL3.27

GTIN: 6418677401473

Description: The cable lugs are used for terminating conductors of up to 1 kV cables. Because of the shear head bolt construction no crimping tools are needed. The required torque is achieved by tightening the bolt until it breaks off. The lugs are longitudinally water tight and they are suitable both for aluminium and copper conductors, solid and stranded, sector shaped and circular.

Package: 50/3150

Unit: PCS



Photo presented is indicative only

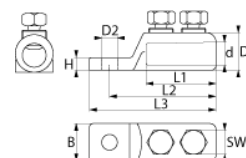

## Technical specification

### Ratings

ETIM class Screw cable lug

### Dimensions

Weight 0.129 kg

Conductor size Al/Cu 95-185

### Drawing markings

B	30 mm
d	19 mm
D1	30 mm
D2	13 mm
H	11 mm
L1	59 mm
L2	85 mm
L3	101 mm
SW	18 mm

### ETIM

Nominal cross section copper, RM	95 ... 185 mm <sup>2</sup>
Nominal cross section copper, RE	95 ... 185 mm <sup>2</sup>
Nominal cross section copper, SM	95 ... 185 mm <sup>2</sup>
Nominal cross section aluminium, RM	95 ... 185 mm <sup>2</sup>
Nominal cross section aluminium, RE	95 ... 185 mm <sup>2</sup>
Nominal cross section aluminium, SM	95 ... 185 mm <sup>2</sup>
Nominal cross section aluminium, SE	95 ... 185 mm <sup>2</sup>
Material conductor	Aluminium/copper
Surface protection	Tinned

Ensto Finland Oy

Ensio Miettisen katu 2  
P.O.Box 77  
06101 Porvoo, Finland

Tel. +358 204 76 21  
Fax +358 204 76 2770

[www.ensto.com](http://www.ensto.com)



*Saves Your Energy*

**PRODUCT CARD**

18.10.2015

2/2

# SAL3.27

With shear-off head

x

---

Ensto Finland Oy

Ensio Miettisen katu 2  
P.O.Box 77  
06101 Porvoo, Finland

Tel. +358 204 76 21  
Fax +358 204 76 2770

[www.ensto.com](http://www.ensto.com)