



Saves Your Energy

PRODUCT CARD

18.10.2015

SMJ1.27

Name: **Shear head bolt connector**

Al/Cu 10-95 mm²

Type: SMJ1.27

GTIN: 6418677446153

Description: The connector is used for jointing conductors of cables up to 36 kV. Because of the shear head bolt construction, no crimping tools are needed. The required torque is achieved by tightening the bolt until it breaks off. The adapter needed in tightening is included in the package.

The connector is water tight. It is suitable for aluminium and copper conductors: solid and stranded, sector shaped and circular. The cable core insulation may be plastic or paper.

Package: 1/10/2100

Unit: PCS



Photo presented is indicative only

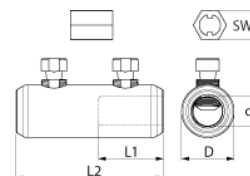

Technical specification

Ratings

ETIM class Connector to screw

Dimensions

Weight 0.115 kg

Conductor size Al/Cu 10-95

Features

For conductor shape Round, Sector, Solid, Stranded

Drawing markings

d 14 mm

D 26 mm

L1 34 mm

L2 70 mm

SW 17 mm

ETIM

Nominal cross section copper, RM 10 ... 95 mm²

Nominal cross section copper, RE 10 ... 95 mm²

Nominal cross section copper, SM 10 ... 95 mm²

Nominal cross section aluminium, RM 10 ... 95 mm²

Nominal cross section aluminium, RE 10 ... 95 mm²

Nominal cross section aluminium, SM 10 ... 95 mm²

Nominal cross section aluminium, SE 10 ... 95 mm²

Material conductor Aluminium/copper

Surface protection Tinned

Ensto Finland Oy

Ensto Miettisen katu 2
P.O.Box 77
06101 Porvoo, Finland

Tel. +358 204 76 21
Fax +358 204 76 2770

www.ensto.com